



OFFICE OF THE CITY CLERK
129 North Second Street
Yakima, Washington 98901
Phone (509) 575-6037 • Fax (509) 576-6614

**CITY OF YAKIMA
NOTICE OF CLOSED RECORD PUBLIC HEARING
Rezone of Property at 408 S. 88th Ave**

NOTICE IS HEREBY GIVEN that the Yakima City Council will conduct a Closed Record Public Hearing to consider the Hearing Examiner's recommendation on the application submitted by Gail Buchanan to rezone 408 S. 88th Avenue from Single-Family Residential (R-1) to Multi-Family Residential (R-3) for the construction of an indoor residential storage facility.

Said closed record public hearing will be held **Tuesday, February 6, 2018 at 6:30 p.m.**, or soon thereafter, in the Council Chambers at City Hall located at 129 North 2nd Street, Yakima, WA.

Closed Record Hearing means the public is invited to testify on the existing Hearing Examiner's records but will not be allowed to introduce any new information.

Any citizen wishing to comment on this request is welcome to attend the closed record public hearing or contact the City Council in the following manner:

- 1) Send a letter via regular mail to "Yakima City Council, 129 N. 2nd Street, Yakima, WA 98901"; or,
- 2) E-mail your comments to citycouncil@yakimawa.gov. Include in the e-mail subject line, "*Buchanan rezone.*" Please also include your name and mailing address.

Dated this 17th day of January 2018.

Sonya Claar Tee, CMC
City Clerk

Mailed: January 19, 2018

VICINITY MAP



File Number: RZ#003-17, CL3#009-17, & SEPA#028-17

Project Name: GAIL BUCHANAN

Site Address: 408 S 88TH AVE

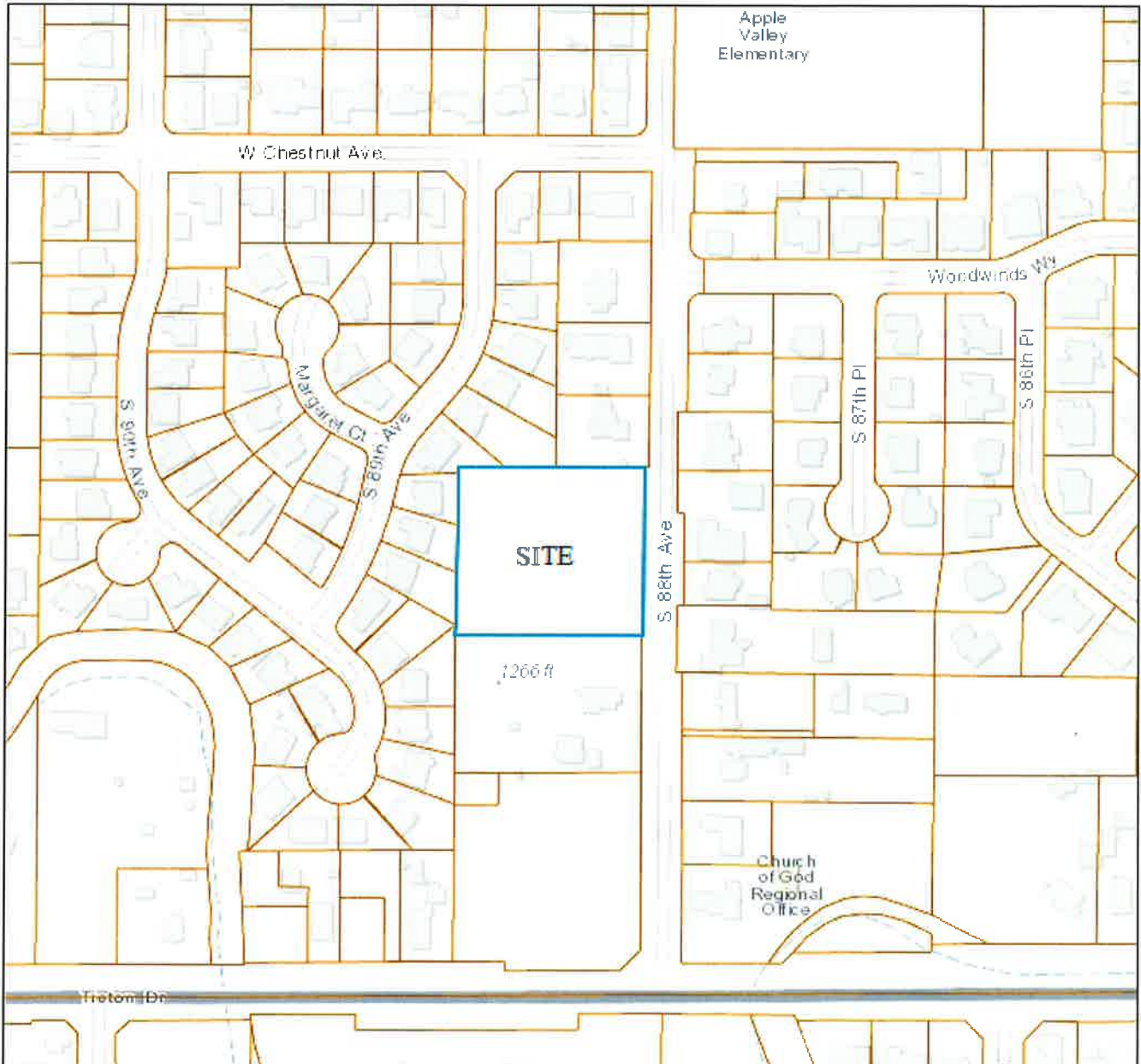

Proposal: Proposal to change the zoning of a 1.78 acre parcel from Single-Family Residential (R-1) to Multifamily Residential (R-3), and proposal to construct a 31,810 sq ft indoor residential storage facility.

Contact the City of Yakima Planning Division at (509) 575-6183

Map Disclaimer: Information shown on this map is for planning and illustration purposes only. The City of Yakima assumes no liability for any errors, omissions, or inaccuracies in the information provided or for any action taken, or action not taken by the user in reliance upon any maps or information provided herein.

Date Created: 1/16/2018

