



OFFICE OF THE CITY CLERK
129 North Second Street
Yakima, Washington 98901
Phone (509) 575-6037 • Fax (509) 576-6614

CITY OF YAKIMA
NOTICE OF PUBLIC HEARING
2022 COMPREHENSIVE PLAN MAP AMENDMENT

NOTICE IS HEREBY GIVEN that the Yakima City Council will conduct an open record public hearing to consider the Yakima Planning Commission's recommendations concerning the 2022 Comprehensive Plan Amendment application. *Open Record Hearing* means the public is invited to testify on the existing Yakima Planning Commission's records or submit new information to the record.

The Washington State Growth Management Act requires cities and counties to adopt land use regulations that are consistent with and implement their comprehensive plan. For 2022, the City of Yakima received one request to amend the City's Future Land Use Map.

The public hearing will be held **Tuesday, October 4, 2022 at 6:00 p.m.**, or soon thereafter, in the Council Chambers at City Hall, 129 N. 2nd Street, Yakima, WA, at the Council's regularly held public meeting.

CPA#001-22, SEPA #011-22, vicinity of N. 40th and Summitview Avenues parcel number 181322-42492, 42486, 42489, 42487, 42488. Request to change a portion of the Future Land Use map designation from Low Density Residential to Community Mixed Use.

Anyone wishing to comment on this request is welcome to attend or call in to the public hearing (information provided on the agenda).

Sonya Claar Tee, CMC
City Clerk

Mailed on or before September 16, 2022.

Project Name: CITY OF YAKIMA PLANNING DIVISION / 40TH AVE & SUMMITVIEW PROPERTIES

Site Address: 103, 105, 107 N 40TH AVE / 3902 SUMMITVIEW AVE

File Number(s): CPA#001-22, SEPA#011-22

Proposal: Proposed change to the Future Land Use map designation for five parcels from Low Density Residential to Community Mixed Use.



VICINITY MAP

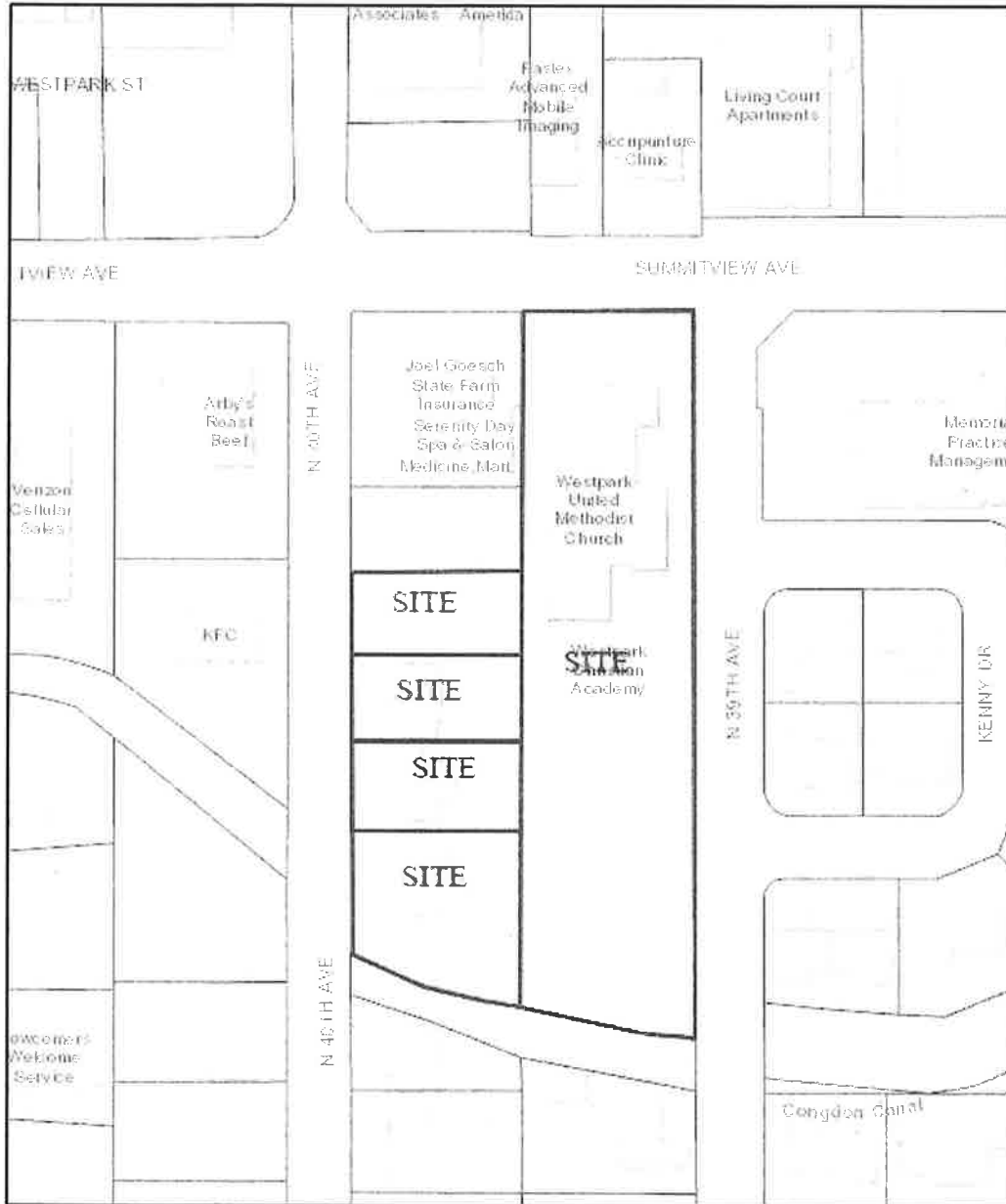

Map Disclaimer: Information shown on this map is for planning and illustration purposes only. The City of Yakima assumes no liability for any errors, omissions, or inaccuracies in the information provided or for any action taken, or action not taken by the user in reliance upon any maps or information provided herein.
Date Created: 5/4/2022

