

*Table F-1*

Maximum Residential Density						
Compatibility Zones	Zone 1	Zone 2	Zone 3	Zone 4	Zone 5	Zone 6
<b>Maximum Residential Density</b>						
<b>Average Number of Dwelling Units Per Gross Acre</b>						
Agricultural (farmland/forest)	0	Maintain current comprehensive plan designation and zoning designation				
Rural (outside an urban growth boundary)	0	1 d.u. per 10 acres	1 d.u. per 10 acres <sup>A</sup>	1 d.u. per 5 acres <sup>A</sup>	1 d.u. per 10 acres <sup>A</sup>	1 d.u. per 5 acres
Urban (within the urban growth boundary)	0	0	B	C	B	C
<b>Maximum Intensities for Nonresidential Uses (Commercial, Industrial, Offices, and Activities)</b>						
<b>Average Number of People Units Per Gross Acre</b>						
Agricultural (farmland/forest)	1-5 <sup>E</sup>	D, E	D, E	D, E	D, F	D
Rural (outside an urban growth boundary)	1-5 <sup>E</sup>	10-25 <sup>E</sup>	10-25 <sup>E</sup>	40-60 <sup>E</sup>	100-150 <sup>E</sup>	100-150 <sup>G</sup>
Urban (within the urban growth boundary)	1-5 <sup>E</sup>	50-75 <sup>E</sup>	80-120 <sup>E</sup>	100-150 <sup>E</sup>	100-150 <sup>E</sup>	No Limit <sup>G</sup>

**Notes:**

- A Cluster to preserve open space to maintain open approach corridor at and near runway ends.
- B Infill development up to average of surrounding residential area is allowed, but is appropriate only if nonresidential uses are not feasible
- C Promote high density and intensity mixed use development (15 or more d.u. per acre)
- D Maintain current comprehensive plan designation and zoning designation.
- E Special Function Land uses should be prohibited.
- F 50-100 people per acre allowed if on airport and aviation-related.
- G Special Function Land uses should be avoided.

Table F-2  
Airport Land Use Matrix

	Compatibility Zones					
	Zone 1	Zone 2	Zone 3	Zone 4	Zone 5	Zone 6
<b>A. Resource Operations</b>						
<b>1. Agricultural (Commercial)</b>						
Agriculture, horticulture, general farming (crops only, not feedlots and stockyards)	P	P	P	P	P	P
Agricultural building	L	L	P	P	P	P
Agricultural chemical sales/storage	X	L	P	P	P	P
Agricultural Housing/Farm labor	X	X	L	P	L	P
Agricultural housing/farm labor	X	X	L	P	L	P
Agricultural market	X	X	P	P	X	P
Agricultural related industries	X	L	P	P	P	P
Animal husbandry	X	L	L	L	X	P
Agricultural feeding operation or stockyards	X	X	X	X	X	X
Agriculture or food processing facility	X	L	P	P	L	P
Livestock auction	X	X	X	L	X	P
Fairgrounds	X	X	X	X	X	P
Floriculture, aquaculture	X	L	P	P	P	P
Fruit bin sales/storage	X	L	P	P	P	P
<b>2. Forest (Commercial)</b>						
General forest silver culture	L	L	P	P	P	P
Forest product processing	X	L	P	P	P	P
<b>3. Mining/Refining/Offsite Hazardous Waste Treatment</b>						
Asphalt paving and roofing materials, rock crushing	X	X	L	L	L	P
Mining including sand and gravel pits	X	L	L	L	X	P
Stockpiling of earthen materials	X	L	L	L	X	P
<b>B. Rural Development</b>						
<b>1. Rural Residential</b>						
Single-family dwelling (large lot, 5 acres or greater*)	X	L	L	P	X	P
Single-family dwelling, rural centers	X	X	L	L	X	L
Residential Cluster Development, 40% open	X	X	LSC	X	X	P
Multi-family dwelling	X	X	X	X	X	P
Temporary farm housing	X	X	P	P	L	P

**Chart Symbols**

- **“L” Limited** – Uses or activities that may be compatible with airport operations depending on their location, size, bulk, height, density and intensity of use.
- **“LSC” Limited Special Conditions** – Development should be moved away from the extended runway centerline. Open space should be devoted to areas that experience elevated risk.
- **“P” permitted** – Uses or activities that should be permitted, however, these activities should be reviewed to ensure that they will not create height hazard obstructions, smoke, glare, electronic, wildlife attractants, or other airspace hazards.
- **“X” Prohibited** – uses or activities that should not be constructed near the airport.

All uses or activities identified herein are subject to intensity and density limitations set forth in Table F-1. Particular attention should be given to developments that when located in combination with other permitted or limited activities may create cumulative impacts on airport operations. All uses should be reviewed to ensure that they will not create airspace hazards.

	Compatibility Zones					
	Zone 1	Zone 2	Zone 3	Zone 4	Zone 5	Zone 6
<b>2. Rural Centers</b>						
Single-family dwelling; up to 12 dwelling units/acre	X	X	L	L	X	L
Two - Four family dwelling (duplex) (*)	X	X	X	X	X	L
Multi-family dwelling; 12-20 units/acre	X	X	L	X	X	P
21+ units/acre	X	X	P	P	X	P
Agriculture/forest/mineral resources or industry (see item A)						
Community services (see item D2)						
Retail and commercial service (see items D4 & D5)						
Industrial/manufacturing (see item D4s & D5)						
<b>C. Education Facilities</b>						
<b>1. Education Facilities</b>						
Junior or community college	X	X	L	L	L	P
Schools, K-12 elementary, middle, senior high	X	X	X	X	X	X
Business school	X	L	L	L	L	P
Vocational schools	X	L	L	L	L	P
<b>D. Urban Development</b>						
<b>1. Residential</b>						
Single-family dwelling; up to 12 dwelling units/acre	X	X	X	X	X	L
Two - four-family dwelling (duplex)(*)	X	X	X	X	X	L
Multi-family dwelling(*): 15 or more	X	X	LSC	X	X	P
Mixed-use office/commercial/residential use	X	X	P	P	X	P
Residential development cluster 40% > open space	X	X	L	L	X	L
Residential infill	X	X	L	L	L	P
Mobile home parks	X	X	L	L	X	L
Boarding house	X	X	L	L	L	L
Retirement homes	X	X	X	X	X	L

### Chart Symbols

- **“L” Limited** – Uses or activities that may be compatible with airport operations depending on their location, size, bulk, height, density and intensity of use.
- **“LSC” Limited Special Conditions** – Development should be moved away from the extended runway centerline. Open space should be devoted to areas that experience elevated risk.
- **“P” permitted** – Uses or activities that should be permitted, however, these activities should be reviewed to ensure that they will not create height hazard obstructions, smoke, glare, electronic, wildlife attractants, or other airspace hazards.
- **“X” Prohibited** – uses or activities that should not be constructed near the airport.

All uses or activities identified herein are subject to intensity and density limitations set forth in Table F-1. Particular attention should be given to developments that when located in combination with other permitted or limited activities may create cumulative impacts on airport operations. All uses should be reviewed to ensure that they will not create airspace hazards.

	Compatibility Zones					
	Zone 1	Zone 2	Zone 3	Zone 4	Zone 5	Zone 6
<b>2. Community Services</b>						
Cemetery	P	P	P	P	L	P
Churches, synagogues, temples	X	X	L	L	X	L
Community center meeting halls, fraternal organizations	X	X	L	L	X	P
Convalescent, nursing home and group homes	X	X	X	X	X	L
Day care facilities, family in-home	X	X	L	L	X	L
Day care center	X	X	L	L	X	L
Funeral home	X	X	P	P	X	P
Police, fire stations, ambulance service	X	L	P	P	P	P
Hospital	X	X	X	X	X	X
Medical clinic	X	X	L	L	X	P
Correction facilities	X	L	L	L	L	L
Libraries	X	X	P	P	X	P
Museums and art galleries	X	X	L	P	P	P
Zoo	X	X	P	P	X	P
<b>3. Amusement and Recreation</b>						
Amusement park (permanent)	X	X	L	L	X	L
Bowling alleys	X	X	P	P	X	P
Campground	X	L	L	P	L	P
Recreational vehicle parks; short term	X	L	L	P	L	P
Drive-in theatres	X	X	L	L	X	P
Fairgrounds	X	X	P	L	L	P
Golf courses	X	L	P	P	X	P
Gymnasiums, exercise facilities	X	L	L	L	L	P
Horse racing tracks, speedways	X	X	X	X	X	X
Miniature golf courses	X	X	P	P	X	P
Movie theatres, auditoriums exhibition halls	X	X	L	L	X	P
Parks	L	L	P	P	L	P
Roller skating rink	X	X	L	L	X	P

### Chart Symbols

- **“L” Limited** – Uses or activities that may be compatible with airport operations depending on their location, size, bulk, height, density and intensity of use.
- **“LSC” Limited Special Conditions** – Development should be moved away from the extended runway centerline. Open space should be devoted to areas that experience elevated risk.
- **“P” permitted** – Uses or activities that should be permitted, however, these activities should be reviewed to ensure that they will not create height hazard obstructions, smoke, glare, electronic, wildlife attractants, or other airspace hazards.
- **“X” Prohibited** – uses or activities that should not be constructed near the airport.

All uses or activities identified herein are subject to intensity and density limitations set forth in Table F-1. Particular attention should be given to developments that when located in combination with other permitted or limited activities may create cumulative impacts on airport operations. All uses should be reviewed to ensure that they will not create airspace hazards.

	Compatibility Zones					
	Zone 1	Zone 2	Zone 3	Zone 4	Zone 5	Zone 6
<b>4. Retail Trade and Service</b>						
Addressing, mailing, and stenographic services	X	L	P	P	L	P
Advertising agencies	X	L	P	P	L	P
Airport uses and activities commercial/industrial	L	P	P	P	P	P
Animal clinic/hospital	L	P	P	P	P	P
Antique stores	X	L	P	P	X	P
Automobile, truck, manufactured home, and travel trailer sales	L	P	P	P	P	P
Automobile and recreational vehicle (RV) sales; weekend	L	P	P	P	L	P
Automotive: car wash	L	P	P	P	L	P
Sales lot/auto center	L	P	P	P	P	P
Parking lots and garages	L	P	P	P	P	P
Maintenance and repair shops	X	P	P	P	P	P
Paint and body repair shops	L	P	P	P	P	P
Parts and accessories (tires, batteries, etc.)	X	P	P	P	P	P
Specialized repair shops (radiator, etc.)	L	P	P	P	P	P
Towing services	L	P	P	P	P	P
Wrecking and dismantling yard	L	P	P	P	L	P
Bakery	X	P	P	P	L	P
Beauty and barber shops	X	L	P	P	X	P
Bed and breakfast inn	X	X	L	L	X	P
Boats and marine accessories	X Except storage L	P	P	P	P	P
Books, stationery, office supplies	Storage only	P	P	P	L	P
Building and trade (plumbing, heating, electrical, painting, etc.)	Storage only	P	P	P	L	P
Clothing and accessories	X	L	P	P	L	P
Communication towers	X	X	L	L	L	L
Computer and electronic stores	X	L	P	P	L	P
Department, discount, variety stores	X	X	P	P	X	P
Drug stores (optical goods, orthopedic supplies)	X	L	P	P	L	P
Employment agencies (private)	X	P	P	P	L	P

#### Chart Symbols

- **“L” Limited** – Uses or activities that may be compatible with airport operations depending on their location, size, bulk, height, density and intensity of use.
- **“LSC” Limited Special Conditions** – Development should be moved away from the extended runway centerline. Open space should be devoted to areas that experience elevated risk.
- **“P” permitted** – Uses or activities that should be permitted, however, these activities should be reviewed to ensure that they will not create height hazard obstructions, smoke, glare, electronic, wildlife attractants, or other airspace hazards.
- **“X” Prohibited** – uses or activities that should not be constructed near the airport.

All uses or activities identified herein are subject to intensity and density limitations set forth in Table F-1. Particular attention should be given to developments that when located in combination with other permitted or limited activities may create cumulative impacts on airport operations. All uses should be reviewed to ensure that they will not create airspace hazards.

	Compatibility Zones					
	Zone 1	Zone 2	Zone 3	Zone 4	Zone 5	Zone 6
Farm and implements, tools and heavy construction equipment	X	L	P	P	P	P
Farm supplies	L	P	P	P	P	P
Financial institutions	X	P	P	P	L	P
Food store	X	P	P	P	L	P
Furniture, home furnishings, appliances	X	P	P	P	L	P
General hardware, garden equipment and supplies	X	P	P	P	L	P
Grocery and convenience stores	X	L	P	P	L	P
Heavy equipment storage, maintenance and repair	X	L	P	P	L	P
Insurance agents, brokers, and service agencies	X	P	P	P	L	P
Kennels	L	P	P	P	L	P
Laundries, laundromats, and dry cleaning plants	X	P	P	P	L	P
Liquor stores	X	P	P	P	L	P
Lumber yards	L	P	P	P	L	P
Medical and dental laboratory, offices and clinic	X	X	L	P	x	P
Mini Storage	L	P	P	P	P	P
Motels and Hotels	X	X	P	P	P	P
Motorcycles sales/repair (including maintenance)	X	P	P	P	L	P
Paint, glass, and wallpaper stores	X	P	P	P	L	P
Pet stores, pet supplies, and dog grooming	X	L	P	P	L	
Professional office buildings for architects, attorneys, government, etc.	X	L	P	P	P	P
Rental: auto, truck, trailer, fleet leasing services	L	P	P	P	L	P
Repairs: small appliances, tv, business machines, watches, etc.	L	P	P	P	L	P
Restaurant, cafe and drive-in eating facilities	X	L	P	P	P	P
Service station	X	L	P	P	L	P
Sporting goods, bicycle shops	X	P	P	P	P	P
Taverns, bars, dance establishments	X	L	P	P	L	P

### Chart Symbols

- **“L” Limited** – Uses or activities that may be compatible with airport operations depending on their location, size, bulk, height, density and intensity of use.
- **“LSC” Limited Special Conditions** – Development should be moved away from the extended runway centerline. Open space should be devoted to areas that experience elevated risk.
- **“P” permitted** – Uses or activities that should be permitted, however, these activities should be reviewed to ensure that they will not create height hazard obstructions, smoke, glare, electronic, wildlife attractants, or other airspace hazards.
- **“X” Prohibited** – uses or activities that should not be constructed near the airport.

All uses or activities identified herein are subject to intensity and density limitations set forth in Table F-1. Particular attention should be given to developments that when located in combination with other permitted or limited activities may create cumulative impacts on airport operations. All uses should be reviewed to ensure that they will not create airspace hazards.

	Compatibility Zones					
	Zone 1	Zone 2	Zone 3	Zone 4	Zone 5	Zone 6
<b>5. Industry/Manufacturing</b>						
Aircraft parts	Storage only	L	P	P	P	P
Aircraft industrial	Storage only	L	P	P	P	P
Apparel and accessories	X	L	P	P	X	P
Bakery products (wholesale)	Storage only	L	P	P	X	P
Beverage industry	Storage only	L	P	P	X	P
Canning, preserving, and packaging fruits, vegetables, and other foods	X	L	L	L	X	P
Cement and concrete plants	X	L	L	L	X	P
Chemicals (industrial, agricultural, wood, etc.)	X	X	L	L	X	L
Concrete, gypsum, and plaster products	Storage only	L	P	L	L	P
Confectionery and related products (wholesale)	Storage only	P	P	P	L	P
Mini storage	P	P	P	P	P	P
Product assembly	Storage only	L	P	P	L	P
Prefabricated structural wood products and containers	Storage only	P	P	P	L	P
Printing, publishing, and binding	Storage only	P	P	P	L	P
Rendering plants, slaughter houses	X	X	X	X	X	L
Rubber products	X	L	P	P	L	P
Sawmills and planing mills	Storage only	L	P	P	L	P
Sheet metal and welding shops	Storage only	P	P	P	L	P
Stone products (includes finishing of monuments for retail sale)	Storage only	P	P	P	L	P

### Chart Symbols

- **“L” Limited** – Uses or activities that may be compatible with airport operations depending on their location, size, bulk, height, density and intensity of use.
- **“LSC” Limited Special Conditions** – Development should be moved away from the extended runway centerline. Open space should be devoted to areas that experience elevated risk.
- **“P” permitted** – Uses or activities that should be permitted, however, these activities should be reviewed to ensure that they will not create height hazard obstructions, smoke, glare, electronic, wildlife attractants, or other airspace hazards.
- **“X” Prohibited** – uses or activities that should not be constructed near the airport.

All uses or activities identified herein are subject to intensity and density limitations set forth in Table F-1. Particular attention should be given to developments that when located in combination with other permitted or limited activities may create cumulative impacts on airport operations. All uses should be reviewed to ensure that they will not create airspace hazards.

	Compatibility Zones					
	Zone 1	Zone 2	Zone 3	Zone 4	Zone 5	Zone 6
<b>6. Wholesale Trade-Storage</b>						
Warehouses	Storage only	P	P	P	P	P
Wholesale trade	Storage only	P	P	P	P	P
Storage facilities; bulk	L	P	P	P	P	P
commercial	L	P	P	P	P	P
mini-storage	L	P	P	P	P	P
<b>E. Transportation and Utilities</b>						
<b>1. Transportation</b>						
Bus terminals	X	L	P	P	L	P
Transportation storage and maintenance facilities	Storage only	P	P	P	P	P
Transportation brokerage offices; without truck parking	X	P	P	P	P	P
with truck parking	L	P	P	P	P	P
Contract truck hauling, rental of trucks with drivers	L	P	P	P	P	P
Rail, truck terminals (for short-term storage, office)	L	P	P	P	P	P
Air storage and office use	Storage only	P	P	P	P	P
Railroad switch yards, maintenance, and repair facilities, etc.	X	P	P	P	P	P
Taxicab terminals, maintenance, and dispatching centers, etc.	X	P	P	P	P	P
<b>2. Utilities</b>						
Power generating facilities	L	L	L	L	L	L
Utility services (substations, etc.)	L	L	L	L	L	P
Wholesale trade	L	P	P	P	L	P
Storage facilities; bulk	L	P	P	P	P	P
Commercial	L	P	P	P	P	P

**Chart Symbols**

- **“L” Limited** – Uses or activities that may be compatible with airport operations depending on their location, size, bulk, height, density and intensity of use.
- **“LSC” Limited Special Conditions** – Development should be moved away from the extended runway centerline. Open space should be devoted to areas that experience elevated risk.
- **“P” permitted** – Uses or activities that should be permitted, however, these activities should be reviewed to ensure that they will not create height hazard obstructions, smoke, glare, electronic, wildlife attractants, or other airspace hazards.
- **“X” Prohibited** – uses or activities that should not be constructed near the airport.

All uses or activities identified herein are subject to intensity and density limitations set forth in Table F-1. Particular attention should be given to developments that when located in combination with other permitted or limited activities may create cumulative impacts on airport operations. All uses should be reviewed to ensure that they will not create airspace hazards.



Airport Runways Under 3000 Feet

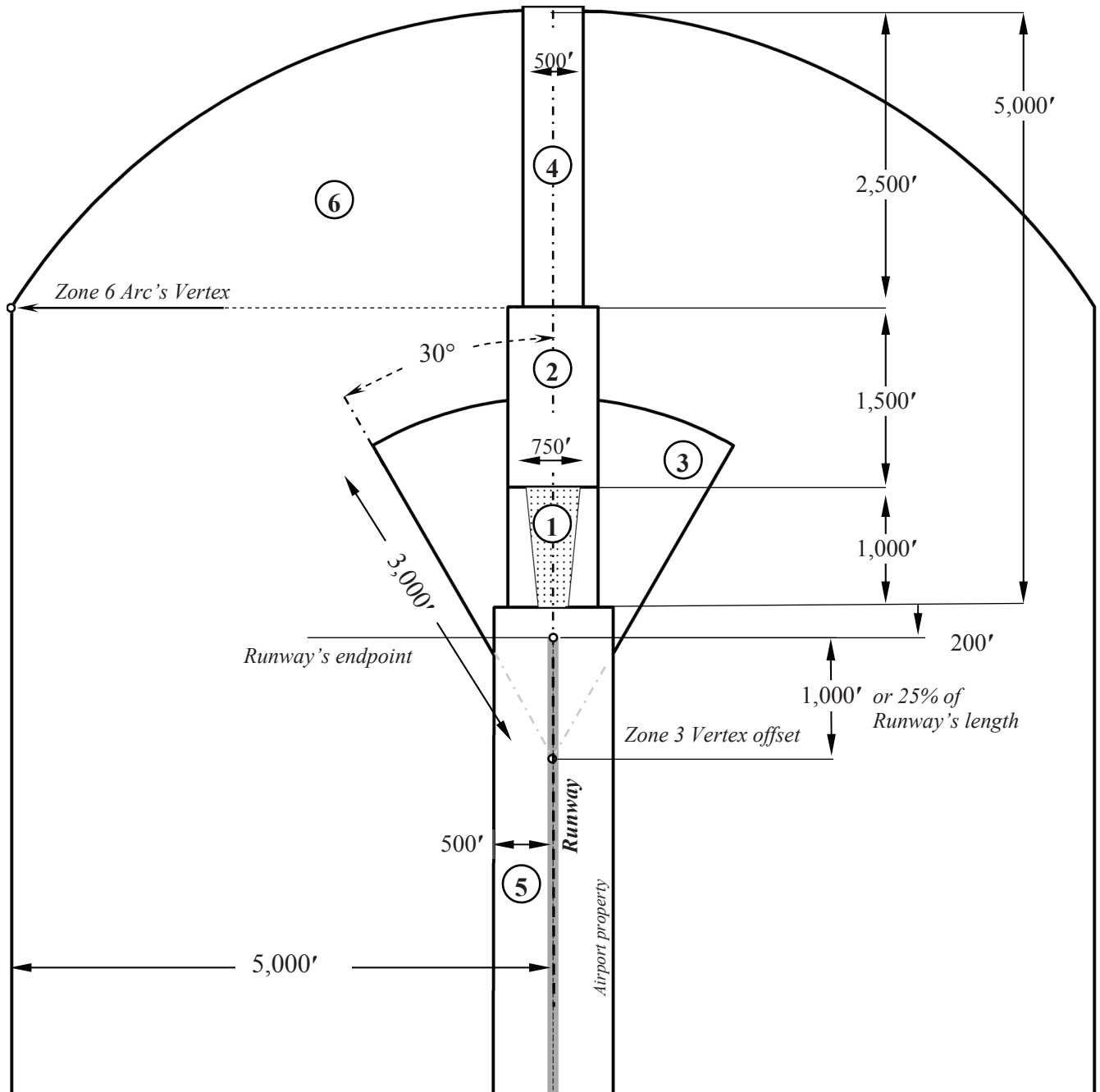

Airport Compatibility Zones			
Dimensions	Length	Width	Notes
Zone 1	1,000'	750'	Zone 1 includes the runway's RPZ. The RPZ is depicted with ordered stipple within Zone 1
Zone 2	1,500'	750'	NA
Zone 3	3,000'	*	*Plot Zone 3's vertex 1,000' from the runway's endpoint or 25% of runway's length
Zone 4	2,500'	500'	NA
Zone 5	*	500'	Zone 5 ends 200' past the runway's endpoint
Zone 6	5,000'	5,000'	Set the vertex for Zone 6's arc parallel to the end of Zone 2

RPZ – Runway Protection Zone

Airport Runways 3,000 to 5,000 Feet

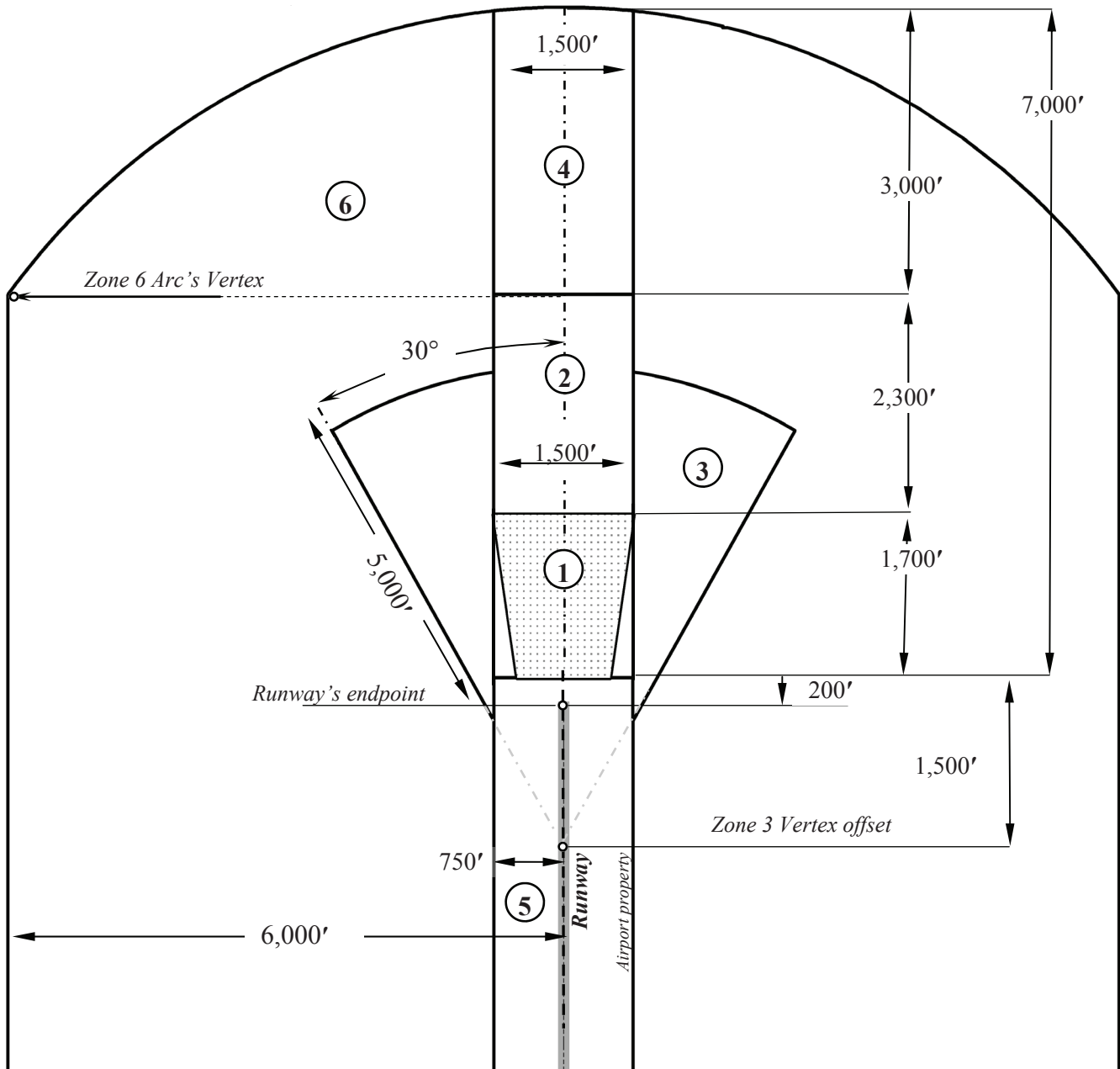

Airport Compatibility Zones			
Dimensions	Length	Width	Notes
Zone 1	1,000'	750*	Zone 1 includes the runway's RPZ. The RPZ is depicted by ordered stipple within Zone 1. *RPZ dimensional standards are dictated by runway approach type.
Zone 2	1,500'	750'	NA
Zone 3	3,000'	*	*Plot Zone 3's vertex 1,500' from the runway's endpoint
Zone 4	2,500'	500'	NA
Zone 5	*	500'	Zone 5 ends 200' past the runway's endpoint
Zone 6	5,000'	5,000'	Set the vertex for Zone 6's arc parallel to the end of Zone 2

RPZ – Runway Protection Zone

Airport Runways Greater Than 5000 Feet

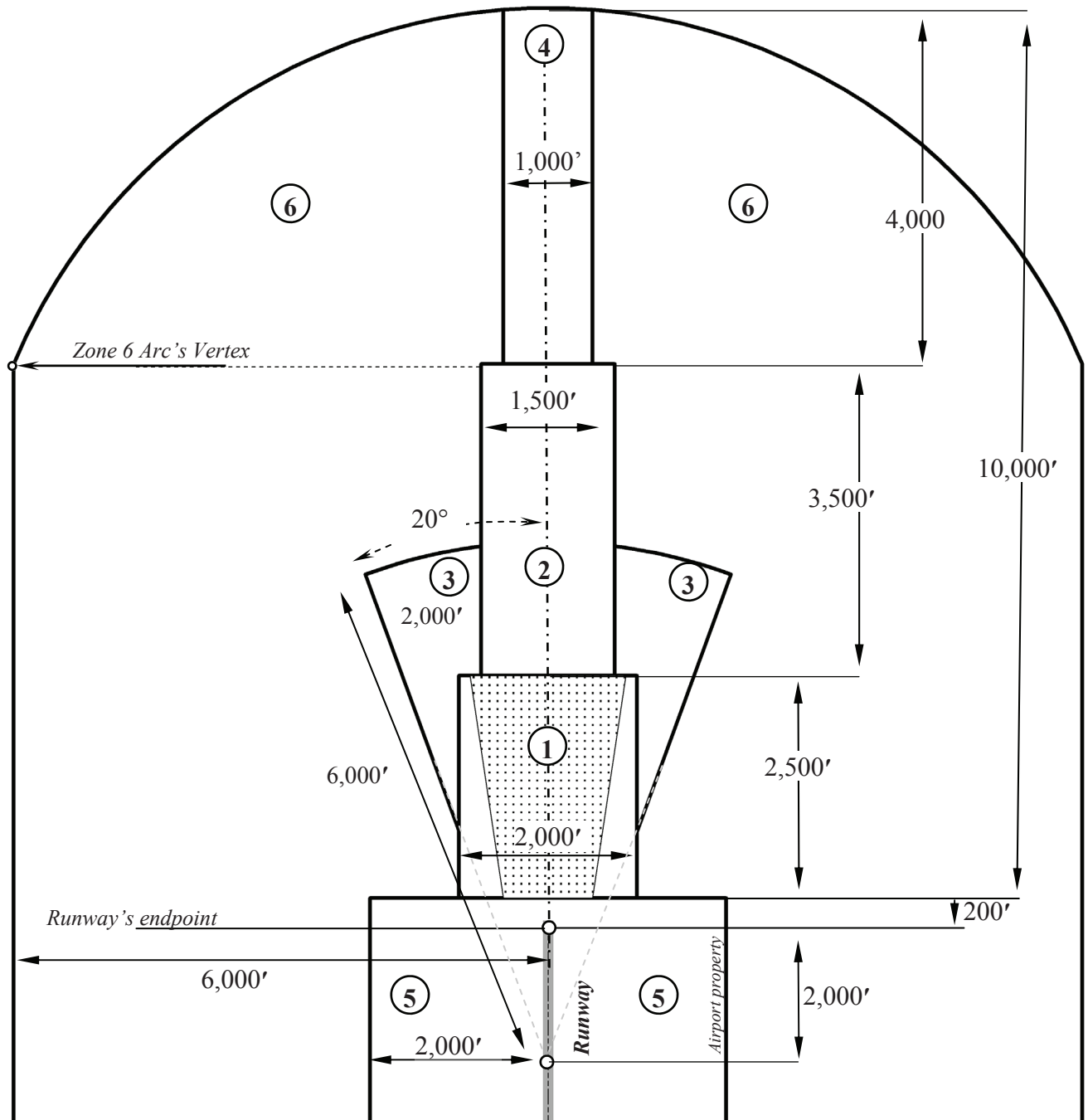

Airport Compatibility Zones			
Dimensions	Length	Width	Notes
Zone 1	2,500'	2,000'	Zone 1 includes the runway's RPZ. The RPZ is depicted with ordered stipple within Zone 1  *RPZ dimensional standards are dictated by runway approach type.
Zone 2	3,500'	1,500'	NA
Zone 3	6,000'	*	*Plot Zone 3's vertex 2,000' from the runway's endpoint
Zone 4	4,000'		NA
Zone 5	*	2,000'	*Zone 5 ends 200' past the runway's endpoint
Zone 6	10,000'	6,000'	Set the vertex for Zone 6's arc parallel to the end of Zone 2

RPZ – Runway Protection Zone

Airport Runway Under 3000 feet 'Single Sided Traffic Pattern Alternative

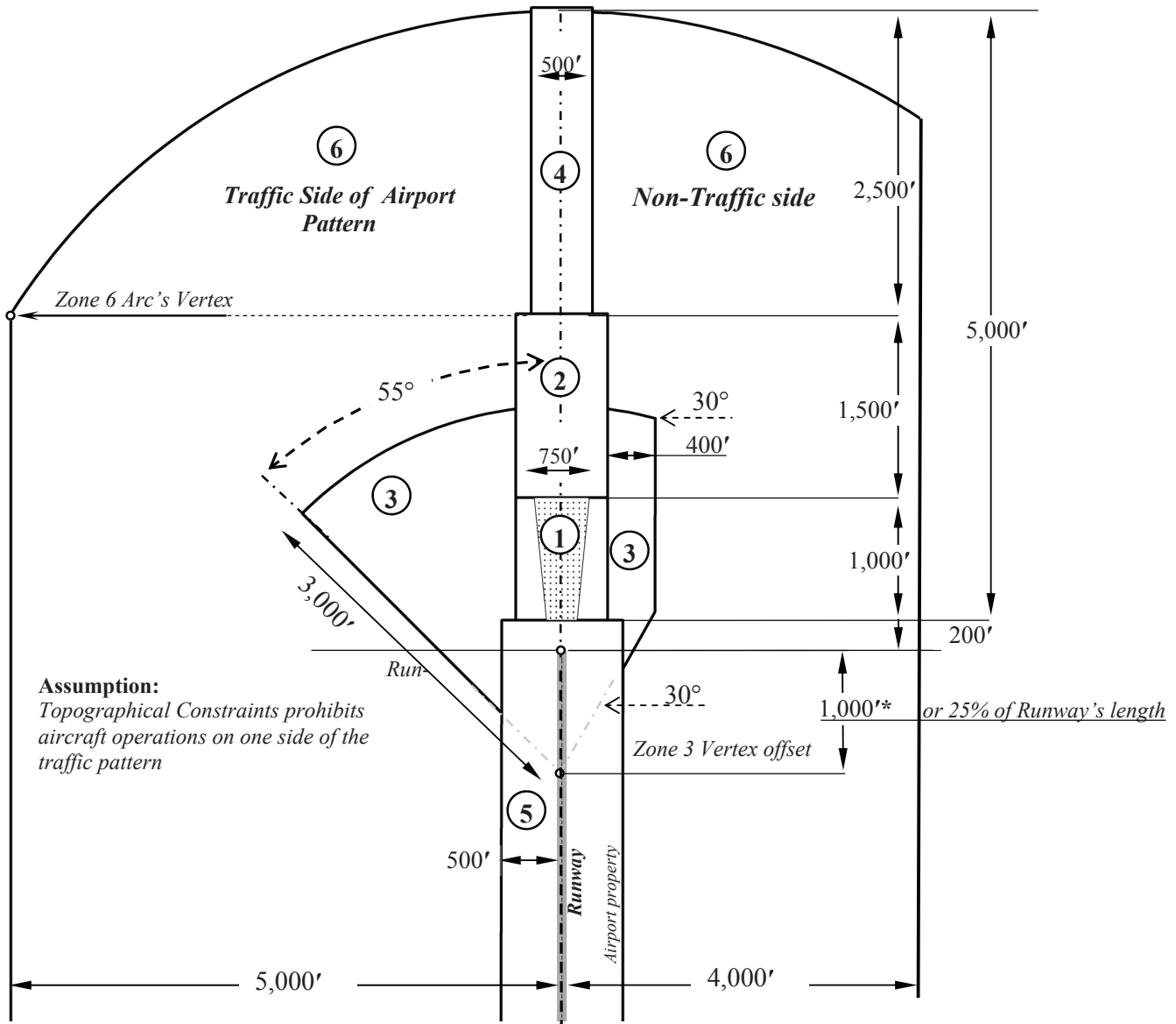

Airport Compatibility Zones			
Dimensions	Length	Width	Notes
Zone 1	2,500'	2,000	Zone 1 includes the runway's RPZ. The RPZ is depicted with ordered stipple within Zone 1. *RPZ dimensional standards are dictated by runway approach type.
Zone 2	3,500'	1,500'	NA
Zone 3	3,000'	3,000'	NA
Zone 4	4,000'		NA
Zone 5	*	2,000'	*Zone 5 ends 200' past the runway's endpoint
Zone 6	10,000'	6,000'	Set the vertex for Zone 6's arc parallel to the end of Zone 2

RPZ – Runway Protection Zone

Airport Runways Greater Than 5,000 Feet: Alternative A

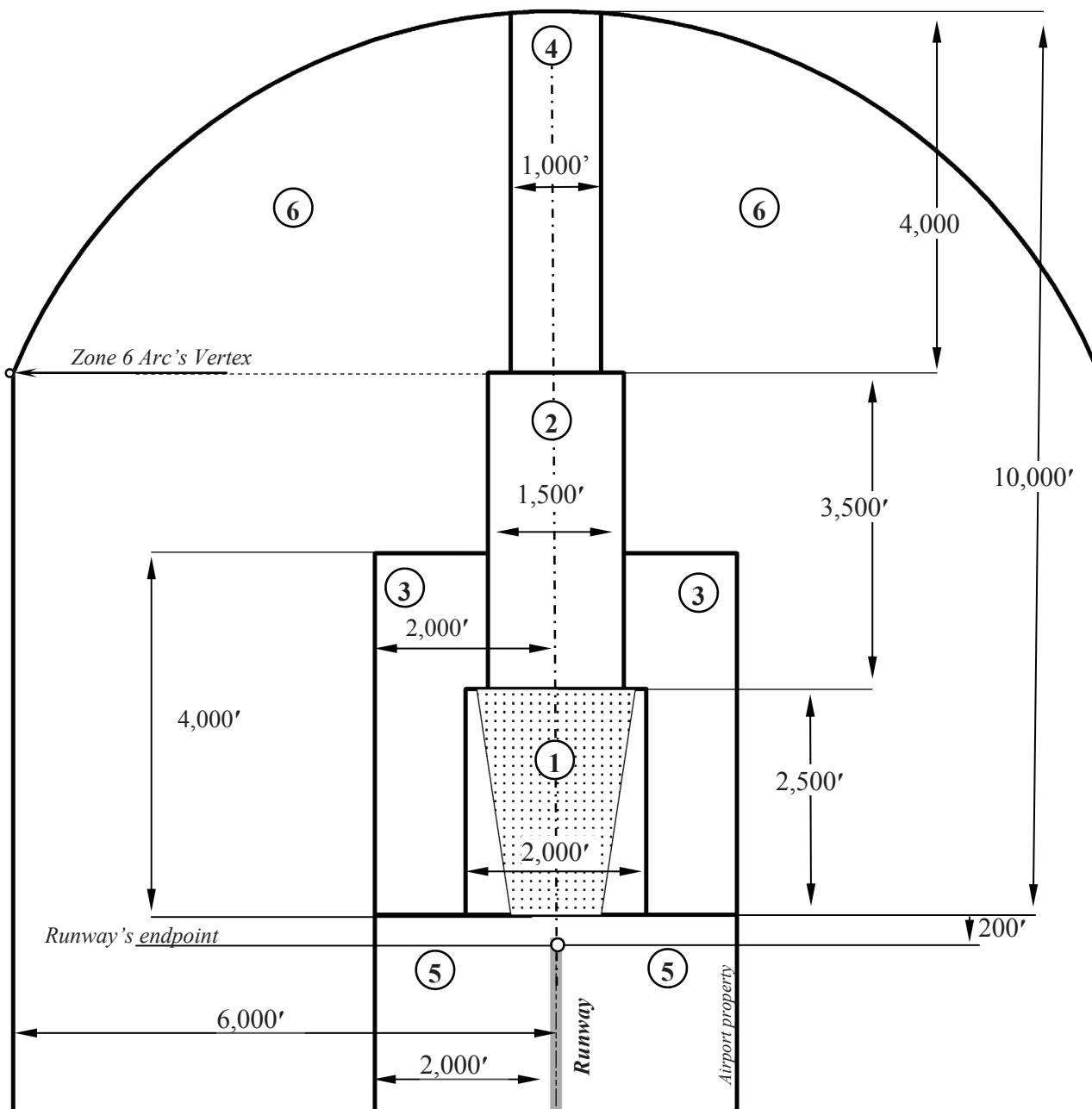

Airport Compatibility Zones			
Dimensions	Length	Width	Notes
Zone 1	1,000'	750'	Zone 1 includes the runway's RPZ. The RPZ is depicted by ordered stipple within Zone 1
Zone 2	1,500'	750'	NA
Zone 3	3,000'	*	*Plot Zone 3's vertex 1,000' from the runway's endpoint or 25% of runway's length. 55° or greater traffic side. 30° with 400' width non-traffic side
Zone 4	2,500'	500'	NA
Zone 5	*	500'	Zone 5 ends 200' past the runway's endpoint
Zone 6	5,000'	5,000'	Set the vertex for Zone 6's arc parallel to the end of Zone 2. 5,000' width traffic side. 4,000' width non traffic side.

RPZ – Runway Protection Zone

